

Brushless DC geared motors

→ 40 W planetary geared motors Ø62 mm

With or without integrated control electronics

- Output in motor shaft
- Ideal for high reduction ratios
- Ideal for high-torque applications
- Excellent efficiency
- Reversible movement



Part numbers

				801496	801496
With built-in electronic control				SNi10	-
Without built-in control, with Hall effect sensors				-	✓
Number of stages	Ratios (i)	Output speed (rpm) 24 V ---	Available torque (Nm)		
1	5.2	423	0.7	●	-
1	5.2	423	0.8	-	●
1	6.75	326	0.9	80149604	-
1	6.75	326	1.1	-	●
2	19.20	115	2.2	●	-
2	19.20	115	2.8	-	●
2	26.86	82	3	●	-
2	26.86	82	3.9	-	●
2	45.96	48	5.1	80149605	-
2	45.96	48	6.6	-	●
3	99.52	22	10	●	-
3	99.52	22	12.5	-	●
3	139.2	16	14	●	-
3	139.2	16	18	-	●
3	236.2	9	23	●	-
3	236.2	9	30	-	●
3	307.5	7	30	80149606	-
3	307.5	7	39	-	●
General characteristics					
Motor				801400	801405
Nominal motor power at 24 V (W)				30 W	40 W
Axial load dynamic (N)				100	100
Radial load dynamic (N)				50 / 70* / 120**	50 / 70* / 120**
Efficiency (%)				90 / 80* / 70**	90 / 80* / 70**
Gearbox case temperature rise (°C)				35	35
Weight (g)				1600 / 1900* / 2200**	1600 / 1900* / 2200**
Protection index				IP54	IP54
Comments					
* 2 nd stage - ** 3 rd stage					

For stages 2 and 3, all gears are metal.

They are also mounted on drawn cup needle bearings for excellent service life.

If you wish to order the geared motor without control electronics but with Hall effect sensors, please specify:

"BDE30-compatible" or "BDE40-compatible", depending on your application

"BDE30-compatible" is supplied with connectors but without a temperature sensor in the motor

"BDE40-compatible" is supplied with bare leads

Product adaptations



- With built-in electronic controls SNi10 or TNi20
- No lead output but connector in motor
- Dimensions of gearbox shaft
- Cable length, with or without connector
- Open-loop control in 2 quadrants
- Low-noise version
- Other windings
- Other reduction ratios
- Mechanical holding brake

Stocked product

Product made to order

To order, see page 18

Dimensions

801496 with SNI10

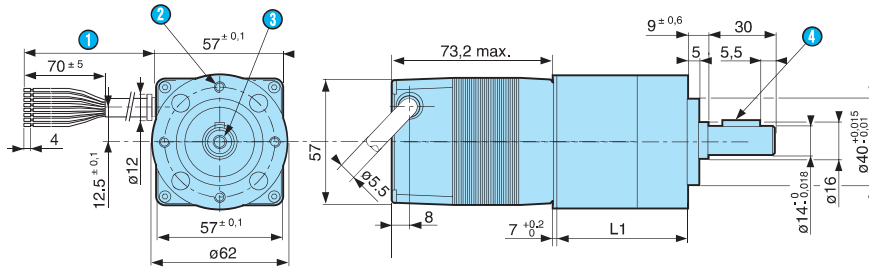

- ① Length of cable 400±10 mm
- ② 4 holes M5 depth 10 at 90° over Ø 52
- ③ Fixing hole M5, depth 12,5
- ④ Key A5 x 5 x 18 DIN 6885 A

L1 1 stage: 43,7 mm max.
 L1 2 stages: 59,7 mm max.
 L1 3 stages: 75,2 mm max.

801496, BDE30-compatible or BDE40-compatible

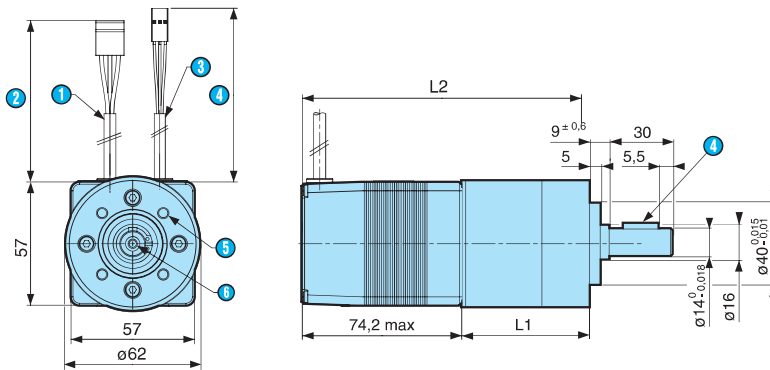

- ① Cable 3 x AWG18
- ② Length of power cable 500±10 mm
- ③ Cable 6 x AWG24
- ④ Length of control cable 500±10 mm
- ⑤ 4 holes M5 depth 10 at 90° over Ø 52
- ⑥ Fixing hole M5, depth 12,5
- ⑦ Parallel key (5x5x18 DIN 6885 A)

L1 1 stage: 43,7 mm
 L1 2 stages: 58,9 mm
 L1 3 stages: 74,8 mm

L2 1 stage: 124 mm max.
 L2 2 stages: 139,8 mm max.
 L2 3 stages: 155,7 mm max.

User information

The limits and precautions for use described in the 30 W brushless motor section must be observed.