

# Single direction synchronous geared motors

→ 0.5 Nm 3 Watts

- Mechanical strength : 0.5 Nm
- Constant speed, dependent on supply frequency
- Wide range of speeds available
- Direction of rotation controlled by long-life mechanical anti-return device
- Permanent magnet rotor



## Specifications

		3 Watts	3 Watts	3 Watts	3 Watts
Type		82 344 0	82 344 0	82 344 0	82 344 0
Direction of rotation		Anti-clockwise	Anti-clockwise	Clockwise	Clockwise
Voltages/Frequencies		230 V 50 Hz	240 V 50 Hz	230 V 50 Hz	240 V 50 Hz
<b>Output speed</b>	<b>Ratios (i)</b>				
60 rpm	10	82 344 744	82 344 736	82 344 698	82 344 690
50 rpm	12	●	●	●	●
50 rpm	20	82 344 738	82 344 746	82 344 692	82 344 700
20 rpm	30	82 344 740	82 344 748	82 344 694	82 344 702
15 rpm	40	82 344 741	82 344 749	82 344 695	82 344 703
12.5 rpm	48	●	●	●	●
12 rpm	50	82 344 743	82 344 751	82 344 697	82 344 705
10 rpm	60	82 344 752	82 344 760	82 344 706	82 344 714
7.5 rpm	80	82 344 754	82 344 762	82 344 708	82 344 716
6 rpm	100	82 344 755	82 344 763	82 344 709	82 344 717
5 rpm	120	82 344 756	82 344 764	82 344 710	82 344 718
4 rpm	150	82 344 765	82 344 767	82 344 719	82 344 721
3 rpm	200	82 344 766	82 344 768	82 344 720	82 344 722
2.5 rpm	240	●	●	●	●
2 rpm	300	82 344 775	82 344 768	82 344 729	82 344 722
1 rpm	600	82 344 771	82 344 778	82 344 725	82 344 732
0.80 rpm	750	●	●	●	●
0.5 rpm	1200	82 344 772	82 344 779	82 344 726	82 344 733
0.33 rpm	1800	82 344 773	82 344 780	82 344 727	82 344 734
0.25 rpm	2400	●	●	●	●
0.20 rpm	3000	●	●	●	●
0.10 rpm	6000	●	●	●	●
5.00 rph	7200	●	●	●	●
4.00 rph	9000	●	●	●	●
3.00 rph	12000	●	●	●	●
2.50 rph	14400	●	●	●	●
1.00 rph	36000	●	●	●	●
0.50 rph	72000	●	●	●	●
1/12 rph	432000	●	●	●	●
1/24 rph	864000	●	●	●	●
<b>General characteristics</b>					
Motor		82 340 0	82 340 0	82 340 0	82 340 0
Gearbox		81 021 0	81 021 0	81 021 0	81 021 0
Maximum permitted torque from gearmotor under continuous conditions for 1 millions turns of the gearmotor (Nm)		0.5	0.5	0.5	0.5
Axial load static (daN)		1	1	1	1
Radial load static (daN)		8	8	8	8
Absorbed power (W)		3	3	3	3
Motor output (W)		0.16	0.16	0.16	0.16
Maximum temperature rise (°C)		55	55	55	55
Ambient temperature (°C)		-5 → +60	-5 → +60	-5 → +60	-5 → +60
Weight (g)		160	160	160	160
Wires length mm (approximately)		250	250	250	250
Protection rating		IP40	IP40	IP40	IP40

To order, see page 13

## Product adaptations

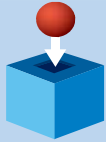

- Special supply voltages
- Special cable lengths
- Special connectors
- Special output shafts
- Special gearbox ratios
- Special gear wheel material
- Special output bearings

## Curves

Graph of torque versus speed 82 344 0

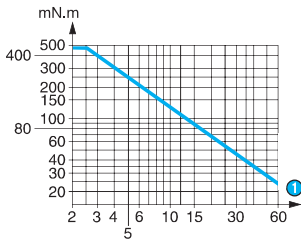

① RPM

## Dimensions

82 344 0

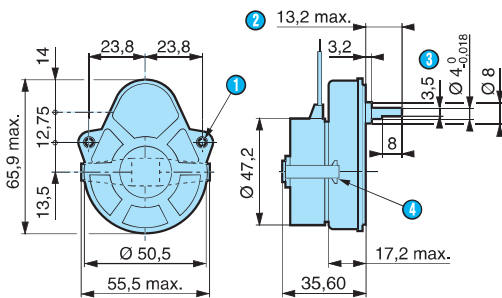

- ① 2 fixing holes Ø 3.2
- ② (pushed-in shaft)
- ③ 3.5 across flat
- ④ Fixing clip

## Options

Shaft 79 200 967

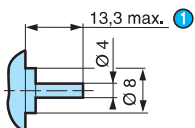

- ① (pushed-in shaft ←)

Shaft 79 200 779

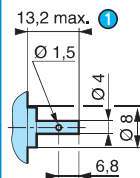

- ① (pushed-in shaft ←)

Shaft 70 999 421 SP1295-10

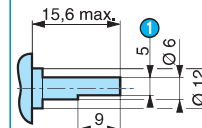

- ① Across flat

## Other information

The speed of a motor powered by a 60 Hz supply is 20 % higher than that of a motor powered by a 50 Hz supply.